

Launch Pin-Tab Transitions to Stripline Design

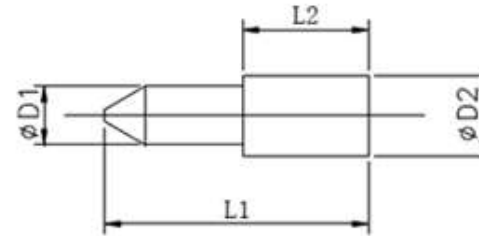
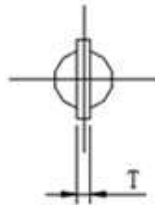

Part Number	D1	D2	L1	L2	T
SP100-09	0.23mm-09 mils	0.23mm-09 mils	1.65mm-65 mils	0.38mm-15 mils	0.10mm-4 mils
SP101-12	0.30mm-12 mils	0.30mm-12 mils	1.91mm-75 mils	0.64mm-25 mils	0.10mm-4 mils
SP102-20	0.51mm-20 mils	0.60mm-24 mils	2.8mm-110 mils	1.00mm-40 mils	0.15mm-5 mils
SP103-36	0.91mm-36 mils	1.27mm-50 mils	4.2mm-165 mils	2.00mm-79 mils	0.20mm-8 mils

Specifications:

Impedance= 50 Ω
 Frequency= DC - 85 Ghz
 Contact Resistance: Center Contact ≤ 1.0 mΩ
 Temperature Range= -55 °C - +165 °C

Material / Finish

Pin-Tab Launch Pin Beryllium Copper Gold plated (MIL-G-45204)

SigaTek

423 Black Oak Ridge Rd.
 Wayne, NJ 07470
 Ph: 973-706-8475, Fax: 973-832-435
 www.sigatek.com

SP10x-xx

Pin-Tab Launch Pin

Dimensions are in inches and (mm)
 Decimal Tolerance:
 2 place +- 0.020
 3 place +- 0.010

CAGE CODE : 69UC1

Notes: All dimensions are typical unless they are specified.
 Specifications are subject to change at any time without any notice.
 Copy or distribution of this drawing in not allowed without Sigatek's approval.